

### Solids Handling Submersible Pumps

## Specifications:

<b>DISCHARGE</b> .....	4", 125 lb. Horizontal Flange Slotted to accommodate 100mm ISO Flanges
<b>LIQUID TEMPERATURE</b> ...	104°F (40°C) Continuous
<b>VOLUTE</b> .....	Cast Iron ASTM A-48, Class 30
<b>MOTOR HOUSING</b> .....	Cast Iron ASTM A-48, Class 30
<b>SEAL PLATE</b> .....	Cast Iron ASTM A-48, Class 30
<b>IMPELLER:</b>	
<i>Design</i> .....	Enclosed Monovane, With Pump Out Vaness on Back Side. Dynamically Balanced ISO G6.3
<i>Material</i> .....	Ductile Iron ASTM A-536, 65-45-12
<b>SHAFT</b> .....	416 Stainless Steel
<b>"O" RINGS</b> .....	Buna-N
<b>HARDWARE</b> .....	300 Series Stainless Steel
<b>LIFTING BAIL</b> .....	300 Series Stainless Steel
<b>PAINT</b> .....	Epoxy Dupont Corlar® Amine Epoxy, Two Coats
<b>SEAL:</b> <i>Design</i> .....	
	Tandem Mechanical, Oil Filled Reservoir.
<i>Material: Inboard</i> ....	Rotating Faces - Carbon Stationary Faces - Ceramic
<i>Material: Outboard</i> ..	Rotating Faces - Silicon Carbide Stationary Faces - Silicon Carbide Elastomer - Buna-N Hardware - 300 Series Stainless
<b>CORD ENTRY</b> .....	Custom Molded, Quick Connected for Sealing and Strain Relief
<b>POWER CORD</b> .....	CSA Certified Submersible Power Cable 2000V - Ordered Separately
<b>SPEED</b> .....	1750 RPM (Nominal)
<b>UPPER BEARING:</b>	
<i>Design</i> .....	Single Row, Ball, Oil Lubricated
<i>Load</i> .....	Radial
<b>LOWER BEARING:</b>	
<i>Design</i> .....	Double Row, Ball, Oil Lubricated
<i>Load</i> .....	Radial & Thrust
<b>MOTOR:</b> <i>Design</i> .....	
	NEMA B Three Phase Torque Curve. Oil-Filled, Squirrel Cage Induction, Inverted duty rated per NEMA MG1
<i>Insulation</i> .....	Class H, Varnish & Magnet Wire
<b>THREE PHASE</b> .....	Tri-voltage 208-230/460V up to 15HP, Dual Voltage 230/460V up to 20 HP, 460V only 25 & 30 HP & 575V; 7.5 thru 30HP. Requires Overload Protection to be Included in control panel.
<b>MOISTURE SENSOR</b> .....	Normally Open (N/O), Requires Relay in Control Panel
<b>TEMPERATURE SENSOR</b> ..	Three Normally Closed (N/C). To be wired in series with contactor control circuit
<b>OPTIONAL EQUIPMENT</b> ..	Seal Material, Impeller Trims, Cord Length, Leg Kit (p/n 125506)
<b>MARKINGS</b> .....	CSA, CE
<b>WEIGHT</b> .....	461 lbs (209 Kg)
<b>NOISE EMISSION MAX</b> ....	In-Air 80 dB-A
<b>SUBMERGENCE</b> .....	Max Depth 66ft (20m)

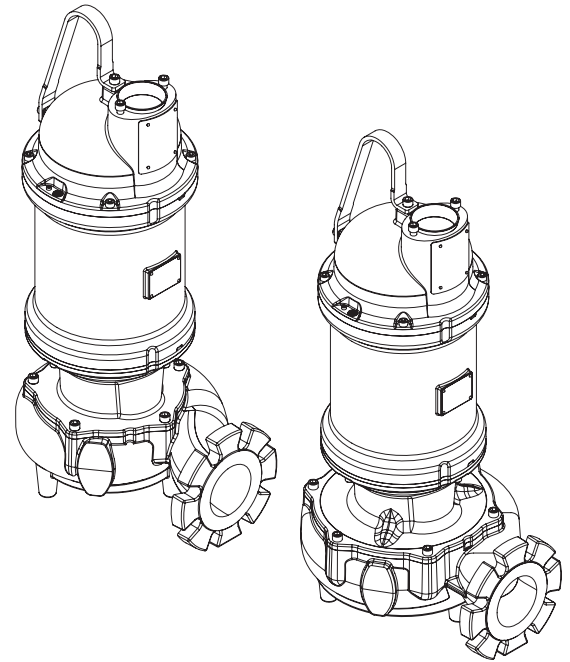

Series: 4SHM  
7.5 - 30HP, 1750RPM, 60Hz



Canadian Standards Association  
File No. LR16567-25



Patent Pending

Sample Specifications: Section 1 Page 21.

### DESCRIPTION:

SUBMERSIBLE NON-CLOG SEWAGE PUMP DESIGNED FOR RAW SEWAGE APPLICATIONS.

**Solids Handling Submersible Pumps**

inches  
(mm)

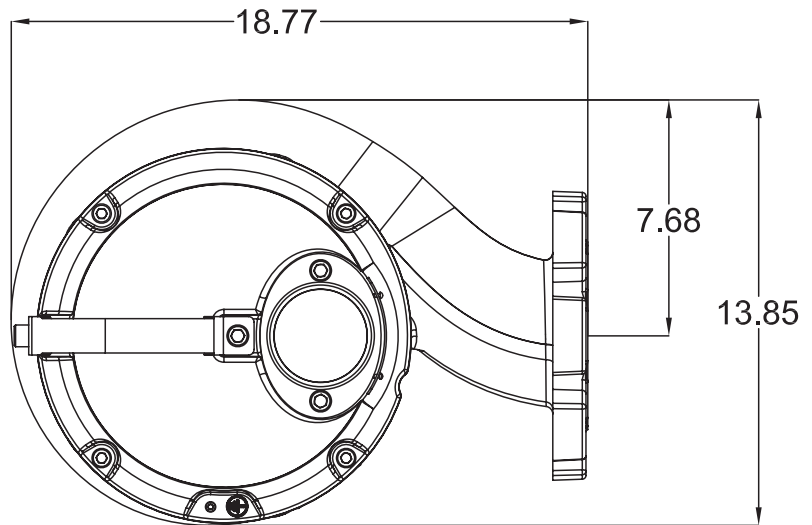
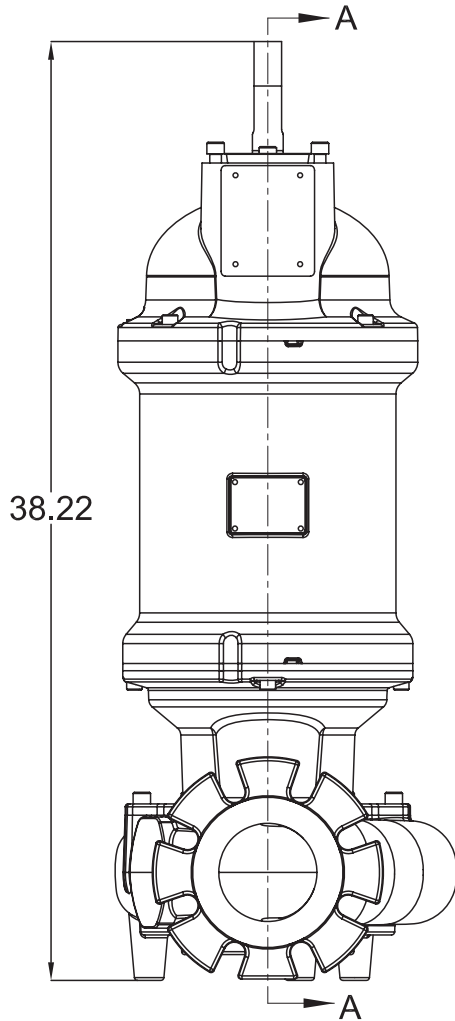

Optional Leg Kit - p/n 125506

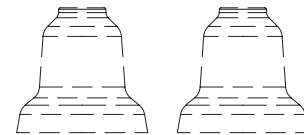

**IMPORTANT !**

- 1.) MOISTURE AND TEMPERATURE SENSORS MUST BE CONNECTED TO VALIDATE THE CSA LISTING.
- 2.) A SPECIAL MOISTURE SENSOR RELAY IS REQUIRED IN THE CONTROL PANEL FOR PROPER OPERATION OF THE MOISTURE SENSORS. CONTACT BARNES PUMPS FOR INFORMATION CONCERNING MOISTURE SENSING RELAYS FOR CUSTOMER SUPPLIED CONTROL PANELS.
- 3.) THESE PUMPS ARE CSA LISTED FOR PUMPING WATER AND WASTEWATER. **DO NOT USE TO PUMP FLAMMABLE LIQUIDS.**
- 4.) INSTALLATIONS SUCH AS DECORATIVE FOUNTAINS OR WATER FEATURES PROVIDED FOR VISUAL ENJOYMENT MUST BE INSTALLED IN ACCORDANCE WITH THE NATIONAL ELECTRIC CODE ANSI/NFPA 70 AND/OR THE AUTHORITY HAVING JURISDICTION. THIS PUMP IS NOT INTENDED FOR USE IN SWIMMING POOLS, RECREATIONAL WATER PARKS, OR INSTALLATIONS IN WHICH HUMAN CONTACT WITH PUMPED MEDIA IS A COMMON OCCURRENCE.
- 5.) THIS PUMP IS NOT APPROPRIATE FOR THOSE APPLICATIONS SPECIFIED AS CLASS 1 DIVISION 1 HAZARDOUS LOCATIONS.

## Solids Handling Submersible Pumps

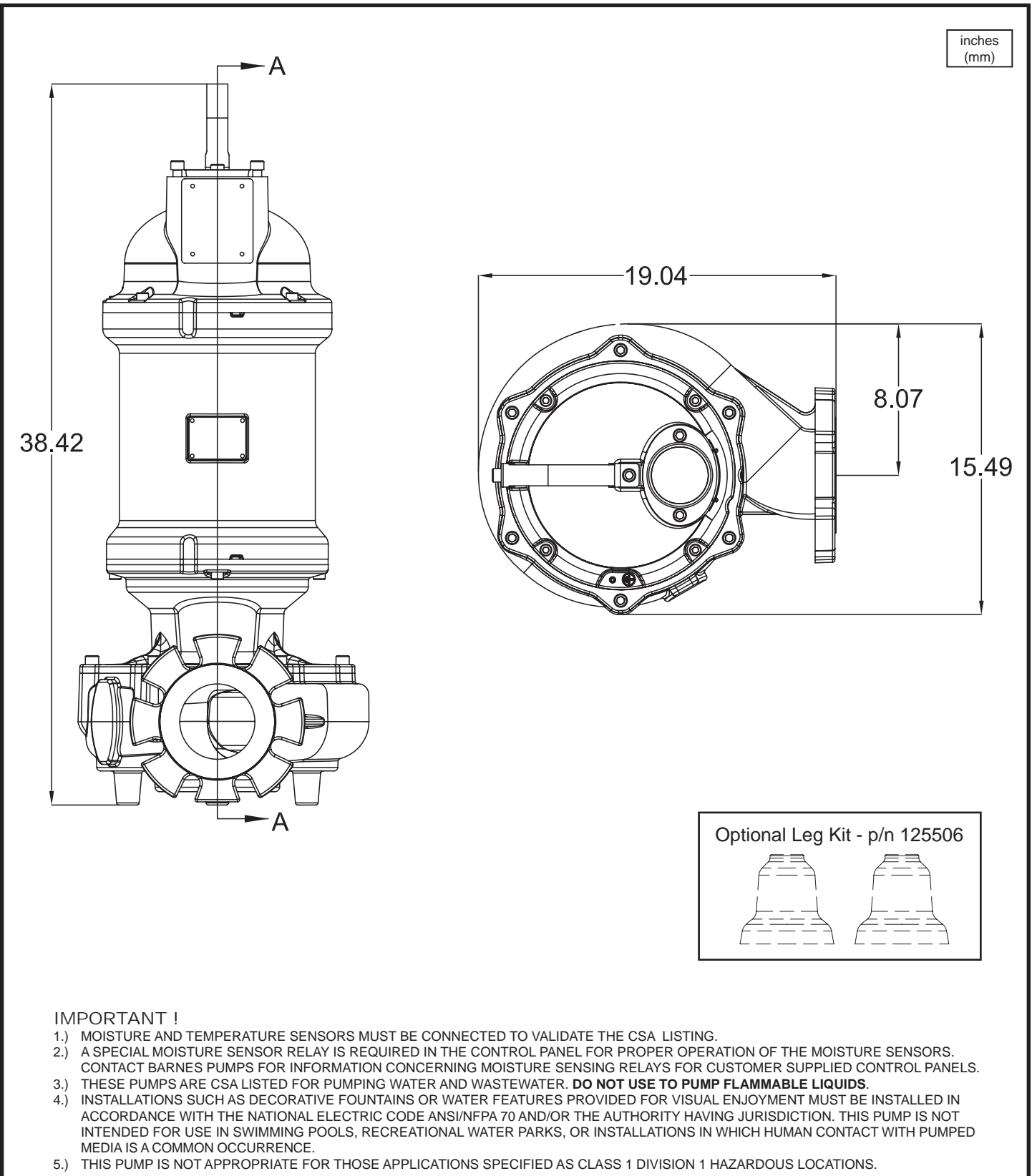

**Solids Handling Submersible Pumps**

MODEL NO	PART NO	"A" DIM	HP	VOLT / Ph	PH	Hz	RPM (Nom)	NEMA START CODE	FULL LOAD AMPS	1.2 SERVICE FACTOR AMPS	LOCKED ROTOR AMPS	CORD P/N
<b>SHMC Pump</b>												
4SHMC75N4	130026	38.2	7.5	208 230 460	3	60	1750	M	35.9 - 32.4/16.2	38.5 - 34.8/17.4	206.6/103.3	125498 125498 125497
4SHMC7554	130027	38.2	7.5	575	3	60	1750	M	13.0	13.9	82.6	125497
4SHMC100N4	130028	38.2	10.0	208 230 460	3	60	1750	K	40.4 - 36.5/18.3	44.6 - 40.3/20.2	206.6/103.3	125498 125498 125497
4SHMC10054	130029	38.2	10.0	575	3	60	1750	K	14.6	16.1	82.6	125497
4SHMC150N4	130030	38.2	15.0	208 230 460	3	60	1750	F	51.8 - 46.9/23.4	59.0 - 54.3/27.2	206.6/103.3	125498 125498 125497
4SHMC15054	130031	38.2	15.0	575	3	60	1750	F	18.7	21.7	82.6	125497
4SHMD150N4	130032	38.4	15.0	208 230 460	3	60	1750	F	51.8 - 46.9/23.4	59.0 - 54.3/27.2	206.6/103.3	125498 125498 125497
4SHMD15054	130033	38.4	15.0	575	3	60	1750	F	18.7	21.7	82.6	125497
4SHMD20084	130034	38.4	20.0	230 460	3	60	1750	J	53.7/26.9	59.0/29.9	383.8/191.9	125498 125497
4SHMD20054	130035	38.4	20.0	575	3	60	1750	J	21.5	23.9	153.5	125497
4SHMD25044	130037	38.4	25.0	460	3	60	1750	G	33.2	38.9	191.9	125499
4SHMD25054	130038	38.4	25.0	575	3	60	1750	G	26.6	31.1	153.5	125497
4SHMD30044	130040	38.4	30.0	460	3	60	1750	F	38.9	45.9	191.9	125499
4SHMD30054	130041	38.4	30.0	575	3	60	1750	F	31.1	36.7	153.5	125499

\*\*\* CORD ORDERED SEPARATELY \*\*\*

Moisture and Temperature sensor leads are integral to power cord.

Winding Resistance 7.5% Winding resistance measured in OHMS @ 25°C (Between Lines) at motor leads.

Pump rated for operation at ± 10% voltage at motor.

Cord Suffix: XF - 50 Feet, XJ - 75 Feet, or XL - 100 Feet

### Solids Handling Submersible Pumps

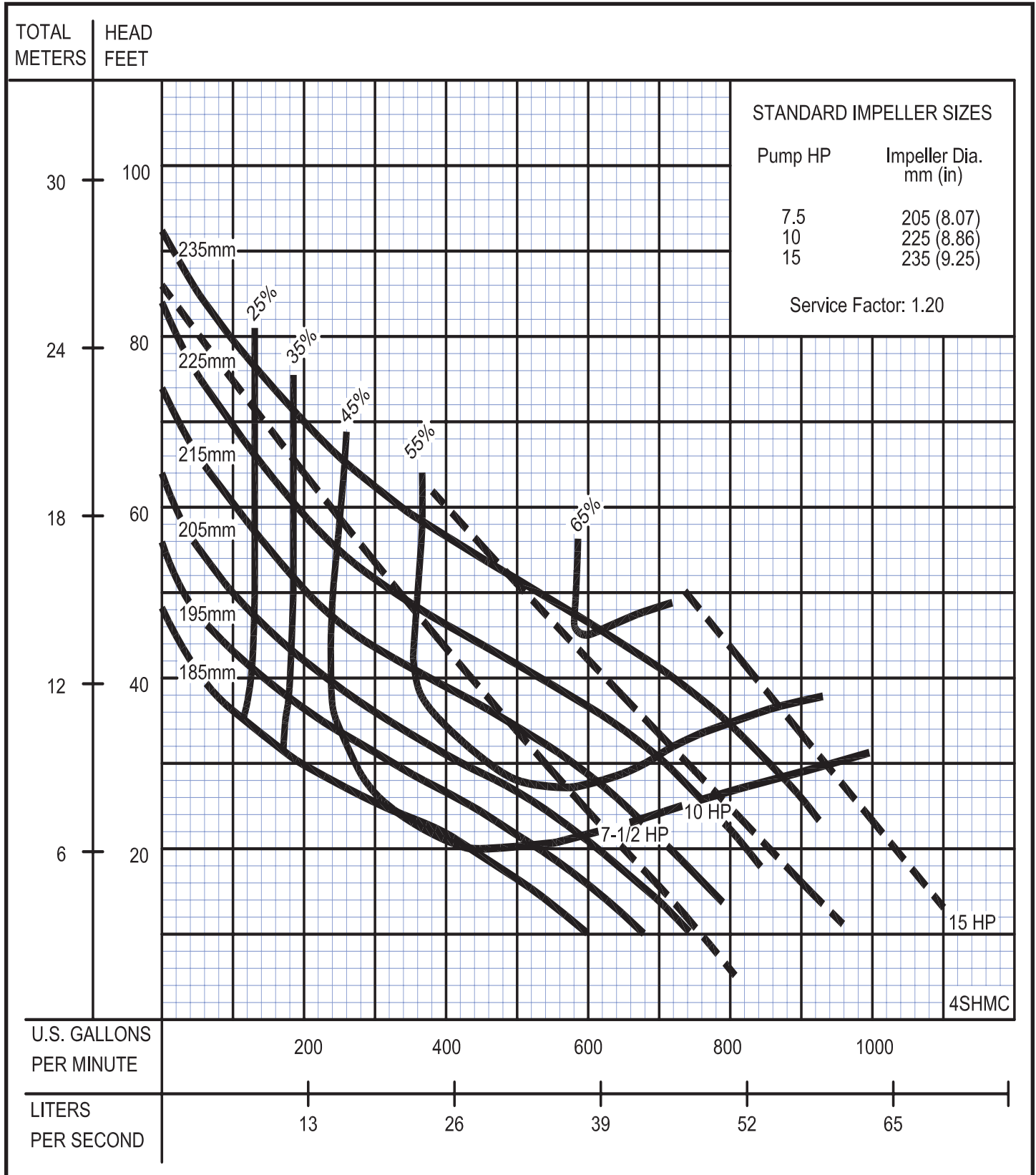

# Series 4SHMD

Performance Curve  
15 - 30HP, 1750RPM, 60Hz



www.cranepumps.com

## Solids Handling Submersible Pumps

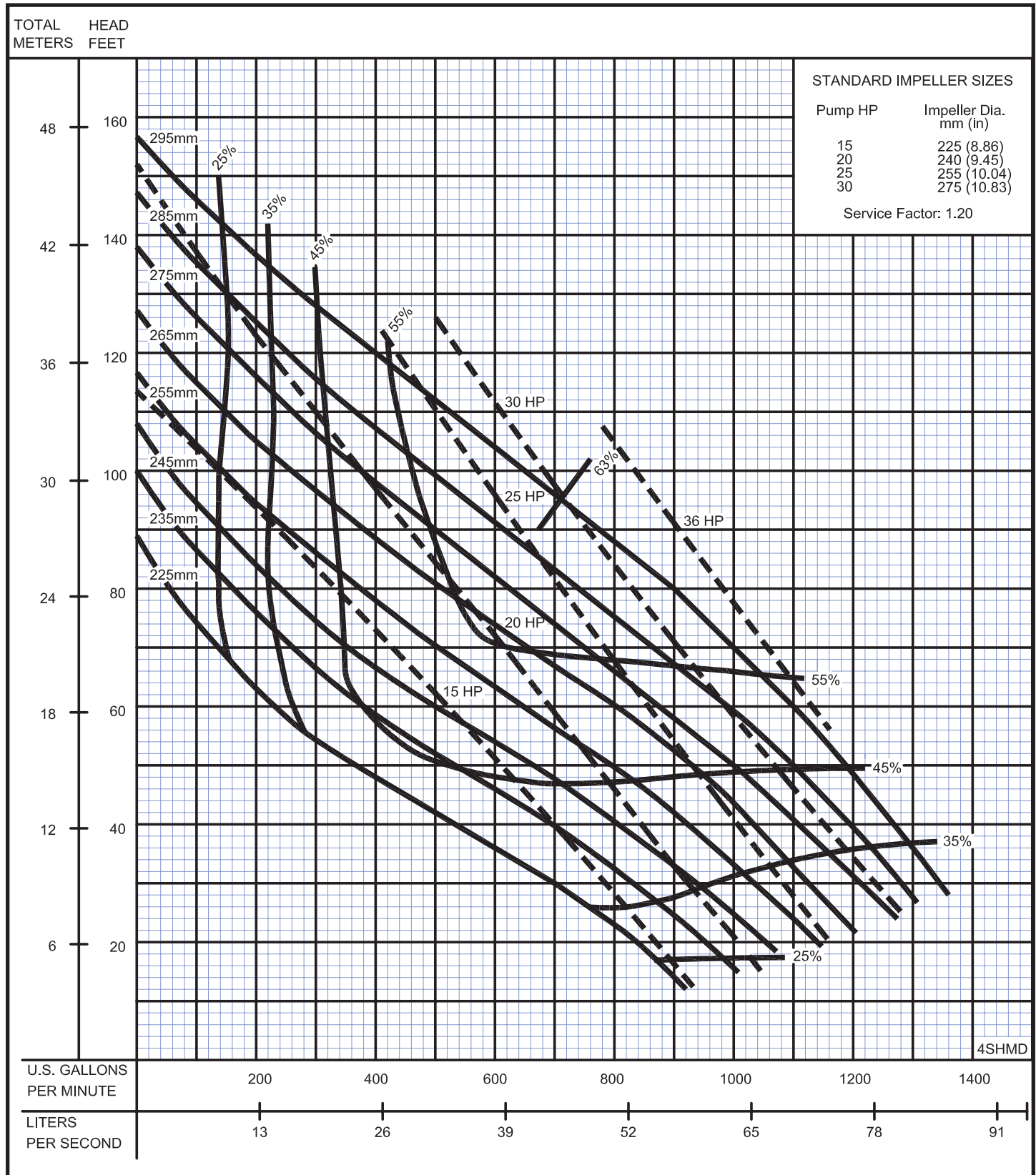

SECTION 0.1A  
PAGE 12  
DATE 12/09



A Crane Co. Company

## PUMPS & SYSTEMS

USA: (937) 778-8947 • Canada: (905) 457-6223 • International: (937) 615-3598